

HZ01 Z Anchors - Product Details

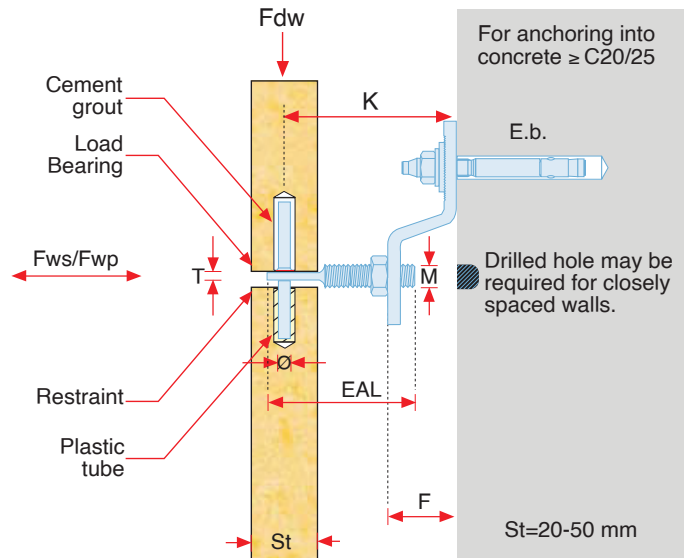
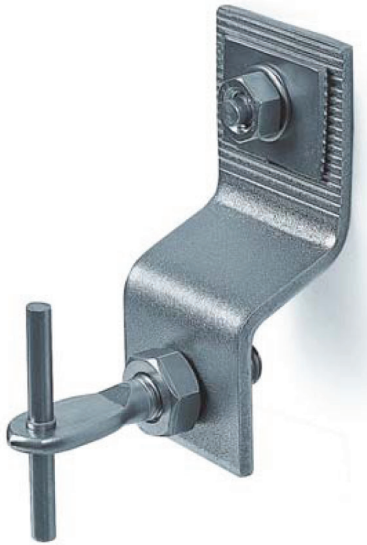

| Product Code | Technical details | | | | | | | | | | | |
|--------------|-------------------|-----------------|-----------------|-----------|--------------|---------------|--------------|---------------------|----------|----------------------|-------------------------|-----------------|
| | Projection | Min. Projection | Max. Projection | Dead Load | Forming Size | Wind-Pressure | Wind-Suction | Expansion Bolt Size | Pin Size | Adj. Arm Metric Size | Adj. Arm Flat Thickness | Adj. Arm Length |
| | K (mm) | K - (mm) | K + (mm) | Fdw (N) | F (mm) | Fwp (N) | Fws (N) | E.b. (mm) | Ø (mm) | M (mm) | T (mm) | EAL (mm) |
| HZ01-452 | 45 | 40 | 55 | 200 | 10 | 312 | 219 | M8X80 | 5 | M10 | 3.5 | 60 |
| HZ01-552 | 55 | 45 | 70 | | 20 | | | | | | | 60 |
| HZ01-752 | 75 | 60 | 90 | | 40 | | | | | | | 60 |
| HZ01-952 | 95 | 80 | 110 | | 60 | | | | | | | 60 |
| HZ01-553 | 55 | 50 | 70 | 300 | 20 | 468 | 328 | M8X80 | 5 | M10 | 3.5 | 60 |
| HZ01-753 | 75 | 60 | 90 | | 40 | | | | | | | 60 |
| HZ01-953 | 95 | 80 | 110 | | 60 | | | | | | | 60 |
| HZ01-1153 | 115 | 100 | 130 | | 80 | | | | | | | 60 |
| HZ01-554 | 55 | 50 | 65 | 400 | 10 | 624 | 437 | M10X90 | 5 | M12 | 4.5 | 70 |
| HZ01-754 | 75 | 60 | 90 | | 20 | | | | | | | 90 |
| HZ01-954 | 95 | 80 | 110 | | 40 | | | | | | | 90 |
| HZ01-1154 | 115 | 100 | 130 | | 60 | | | | | | | 90 |
| HZ01-755 | 75 | 60 | 90 | 500 | 20 | 780 | 546 | M10X90 | 5 | M12 | 4.5 | 90 |
| HZ01-955 | 95 | 80 | 110 | | 40 | | | | | | | 90 |
| HZ01-1155 | 115 | 100 | 130 | | 60 | | | | | | | 90 |
| HZ01-1355 | 135 | 120 | 150 | | 80 | | | | | | | 90 |

- Material: Stainless Steel 1.4301 (A2) & 1.4401 (A4).
- Table above is prepared according to Eurocode standards.
- Loads stated are working resistance loads.
- Other sizes are available for production upon request.
- Bolts are provided separately.
- Structural calculation reports are available upon order.

HZ01 Z Anchor

- Load bearing & restraint
- Three dimensional adjustability
- Fastened on to load bearing walls with expansion bolts and on to channels with set screws
- Projection sizes between 45 and 150 mm
- Suitable for horizontal & vertical joints
- Loads up to 500 N
- Stone thickness 20-50 mm

Product Code Description

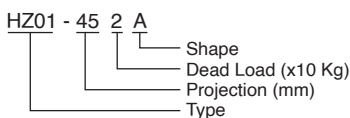

Shape A

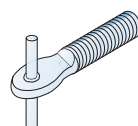

Shape B

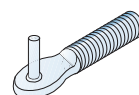

Shape C

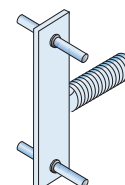

Shape D

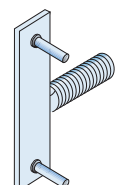

HZ02 Z Anchors - Product Details

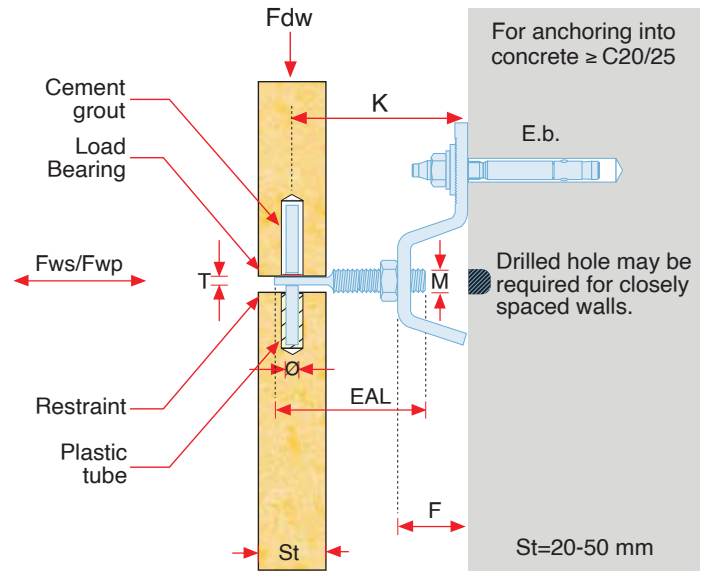
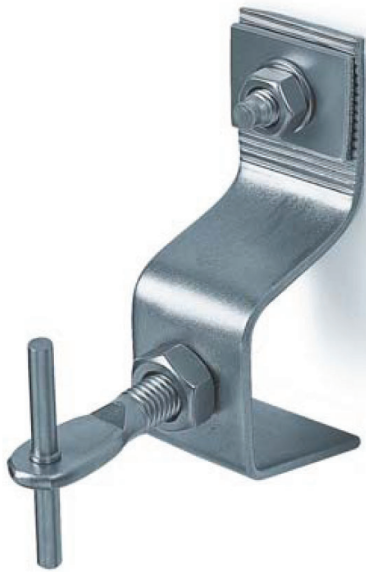

| Product Code | Technical Details | | | | | | | | | | | |
|--------------|-------------------|-----------------|-----------------|-----------|--------------|---------------|--------------|---------------------|----------|----------------------|-------------------------|-----------------|
| | Projection | Min. Projection | Max. Projection | Dead Load | Forming Size | Wind-Pressure | Wind-Suction | Expansion Bolt Size | Pin Size | Adj. Arm Metric Size | Adj. Arm Flat Thickness | Adj. Arm Length |
| | K (mm) | K - (mm) | K + (mm) | Fdw (N) | F (mm) | Fwp (N) | Fws (N) | E.b. (mm) | Ø (mm) | M (mm) | T (mm) | EAL (mm) |
| HZ02-452 | 45 | 40 | 55 | 200 | 10 | 312 | 219 | M8X80 | 5 | M10 | 3.5 | 60 |
| HZ02-552 | 55 | 45 | 70 | | 20 | | | | | | | 60 |
| HZ02-752 | 75 | 60 | 90 | | 40 | | | | | | | 60 |
| HZ02-952 | 95 | 80 | 110 | | 60 | | | | | | | 60 |
| HZ02-553 | 55 | 45 | 70 | 300 | 20 | 468 | 328 | M8X80 | 5 | M10 | 3.5 | 60 |
| HZ02-753 | 75 | 60 | 90 | | 40 | | | | | | | 60 |
| HZ02-953 | 95 | 80 | 110 | | 60 | | | | | | | 60 |
| HZ02-1153 | 115 | 100 | 130 | | 80 | | | | | | | 60 |
| HZ02-554 | 55 | 45 | 65 | 400 | 10 | 624 | 437 | M8X80 | 5 | M12 | 4.5 | 70 |
| HZ02-754 | 75 | 60 | 90 | | 20 | | | | | | | 90 |
| HZ02-954 | 95 | 80 | 110 | | 40 | | | | | | | 90 |
| HZ02-1154 | 115 | 100 | 130 | | 60 | | | | | | | 90 |
| HZ02-755 | 75 | 60 | 90 | 500 | 20 | 780 | 546 | M8X80 | 5 | M12 | 4.5 | 90 |
| HZ02-955 | 95 | 80 | 110 | | 40 | | | | | | | 90 |
| HZ02-1155 | 115 | 100 | 130 | | 60 | | | | | | | 90 |
| HZ02-1355 | 135 | 120 | 150 | | 80 | | | | | | | 90 |
| HZ02-756 | 75 | 60 | 90 | 600 | 20 | 936 | 655 | M10X90 | 6 | M14 | 5.5 | 90 |
| HZ02-956 | 95 | 80 | 110 | | 40 | | | | | | | 90 |
| HZ02-1156 | 115 | 100 | 130 | | 60 | | | | | | | 90 |
| HZ02-1356 | 135 | 120 | 150 | | 80 | | | | | | | 90 |
| HZ02-758 | 75 | 60 | 90 | 800 | 20 | 1235 | 865 | M10X90 | 6 | M14 | 5.5 | 90 |
| HZ02-958 | 95 | 80 | 110 | | 40 | | | | | | | 90 |
| HZ02-1158 | 115 | 100 | 130 | | 60 | | | | | | | 90 |
| HZ02-1358 | 135 | 120 | 150 | | 80 | | | | | | | 90 |

• Material : Stainless Steel 1.4301 (A2) & 1.4401 (A4). • Table above is prepared according to Eurocode standard. • Loads stated are working resistance loads. • Other sizes are available for production upon request. • Bolts are provided separately. • Structural calculation reports are available upon order.

HZ02 Z Anchor

- Load bearing & restraint
- Three dimensional adjustability
- Fastened on to load bearing walls with expansion bolts and on to channels with set screws
- Projection sizes between 45 and 150 mm
- Suitable for horizontal & vertical joints
- Loads up to 800 N
- Stone thicknesses 20-50 mm

Product Code Description

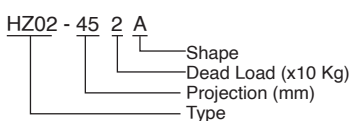

Shape A

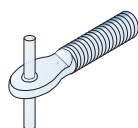

Shape B

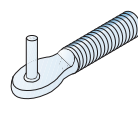

Shape C

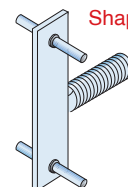

Shape D

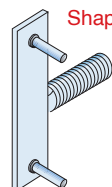

HZ05 Z Anchor with riveted nut - Product Details

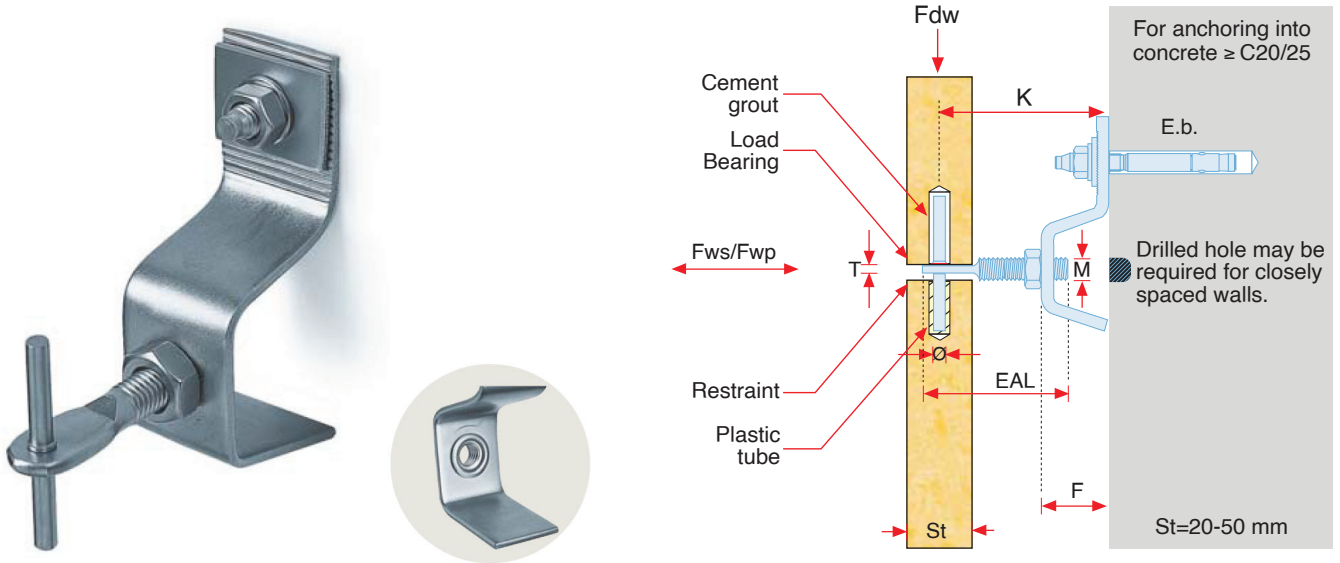

| Product Code | Technical Details | | | | | | | | | | | |
|--------------|-------------------|-----------------|-----------------|-----------|--------------|---------------|--------------|---------------------|----------|----------------------|-------------------------|-----------------|
| | Projection | Min. Projection | Max. Projection | Dead Load | Forming Size | Wind-Pressure | Wind-Suction | Expansion Bolt Size | Pin Size | Adj. Arm Metric Size | Adj. Arm Flat Thickness | Adj. Arm Length |
| | K (mm) | K - (mm) | K + (mm) | Fdw (N) | F (mm) | Fwp (N) | Fws (N) | E.b. (mm) | Ø (mm) | M (mm) | T (mm) | EAL (mm) |
| HZ05-452 | 45 | 40 | 55 | 200 | 10 | 312 | 219 | M8X80 | 5 | M10 | 3.5 | 60 |
| HZ05-552 | 55 | 45 | 70 | | 20 | | | | | | | 60 |
| HZ05-752 | 75 | 60 | 90 | | 40 | | | | | | | 60 |
| HZ05-952 | 95 | 80 | 110 | | 60 | | | | | | | 60 |
| HZ05-553 | 55 | 50 | 70 | 300 | 20 | 468 | 328 | M8X80 | 5 | M10 | 3.5 | 70 |
| HZ05-753 | 75 | 60 | 90 | | 40 | | | | | | | 70 |
| HZ05-953 | 95 | 80 | 110 | | 60 | | | | | | | 70 |
| HZ05-1153 | 115 | 100 | 130 | | 80 | | | | | | | 70 |
| HZ05-554 | 55 | 50 | 65 | 400 | 10 | 624 | 437 | M8X80 | 5 | M12 | 4.5 | 70 |
| HZ05-754 | 75 | 60 | 90 | | 20 | | | | | | | 90 |
| HZ05-954 | 95 | 80 | 110 | | 40 | | | | | | | 90 |
| HZ05-1154 | 115 | 100 | 130 | | 60 | | | | | | | 90 |
| HZ05-755 | 75 | 60 | 90 | 500 | 20 | 780 | 546 | M8X80 | 5 | M12 | 4.5 | 90 |
| HZ05-955 | 95 | 80 | 110 | | 40 | | | | | | | 90 |
| HZ05-1155 | 115 | 100 | 130 | | 60 | | | | | | | 90 |
| HZ05-1355 | 135 | 120 | 150 | | 80 | | | | | | | 90 |

- Material : Stainless Steel 1.4301 (A2) & 1.4401 (A4).
- Table above is prepared according to Eurocode standard.
- Loads stated are working resistance loads.
- Other sizes are available for production upon request.
- Bolts are provided separately.
- Structural calculation reports are available upon order.

HZ05 Z Anchor

- Load bearing & restraint
- Three dimensional adjustability
- Fastened on to load bearing walls with expansion bolts and on to channels with set screws
- Projection sizes between 45 and 150 mm
- Suitable for horizontal & vertical joints
- Loads up to 500 N
- Stone thickness 20-50 mm

Product Code Description

HZ05 - 45 2 A

- Shape
- Dead Load (x10 Kg)
- Projection (mm)
- Type

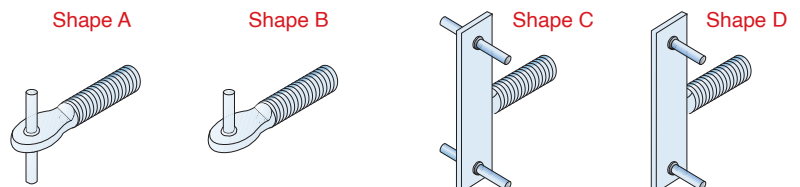

HRS01 Restraint Anchor- Product Details

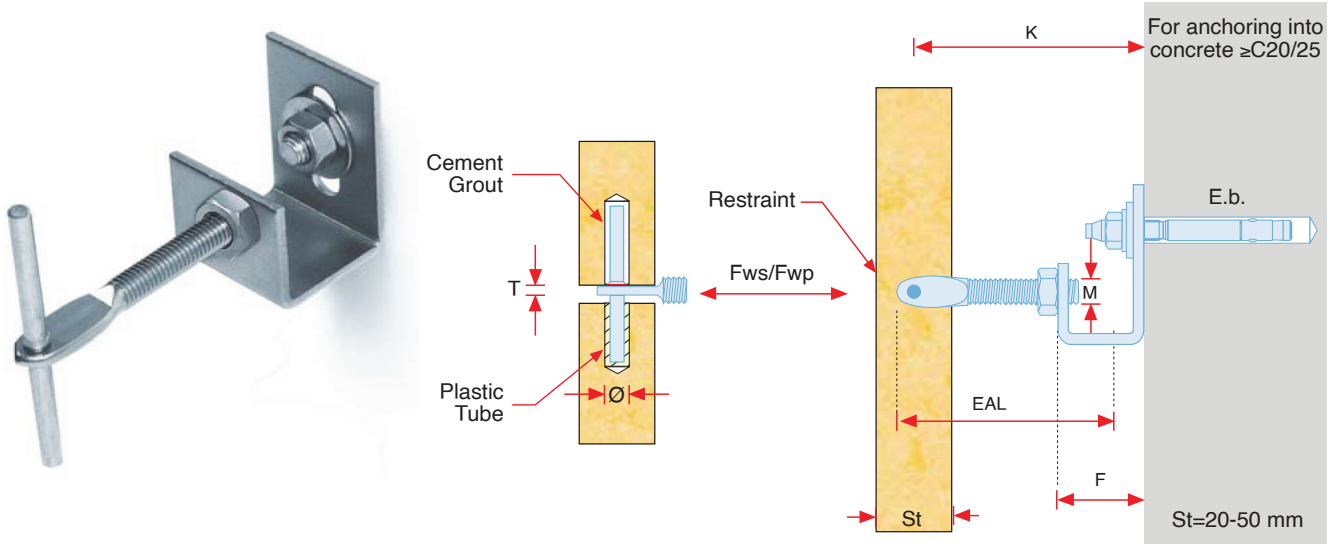

| Product Code | Technical Details | | | | | | | | | | |
|--------------|-------------------|-----------------|-----------------|--------------|---------------|--------------|---------------------|----------|----------------------|-------------------------|-----------------|
| | Projection | Min. Projection | Max. Projection | Forming Size | Wind-Pressure | Wind-Suction | Expansion Bolt Size | Pin Size | Adj. Arm Metric Size | Adj. Arm Flat Thickness | Adj. Arm Length |
| | K (mm) | K - (mm) | K + (mm) | F (mm) | Fwp (N) | Fws (N) | E.b. (mm) | Ø (mm) | M (mm) | T (mm) | EAL (mm) |
| HRS1-55 * | 55 | 45 | 60 | 20 | 312 | 219 | M8X80 | 5 | M8 | 3 | 60 |
| HRS1-75 | 75 | 60 | 90 | 40 | | | | | | | 60 |
| HRS1-95 | 95 | 80 | 110 | 60 | | | | | | | 60 |
| HRS1-115 | 115 | 100 | 130 | 60 | | | | | | | 80 |
| HRS1-135 | 135 | 115 | 150 | 60 | | | | | | | 100 |
| HRS1-155 | 155 | 135 | 170 | 60 | | | | | | | 120 |

- Material : Stainless Steel 1.4301 (A2) & 1.4401 (A4).
- Table above is prepared according to Eurocode standard.
- Loads stated are working resistance loads.
- Other sizes are available for production upon request.
- Bolts are provided separately.
- Structural calculation reports are available upon order.
- Available in sizes to fit the projection range of all HZ anchors.
- (*) In case of back adjustment shorter adj. arms should be used.

HRS1 Restraint Anchor

- Load bearing & restraint
- Three dimensional adjustability
- Fastened on to load bearing walls with expansion bolts and on to channels with set screws
- Projection sizes between 45 and 150 mm
- Suitable for horizontal & vertical joints

- Loads up to 312 N
- Stone thickness 20-50 mm

Product Code Description

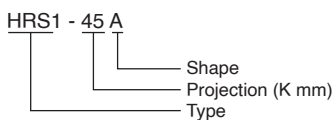

Shape A

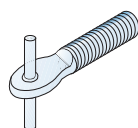

Shape B

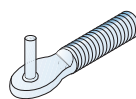

Shape C

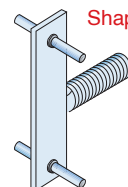

Shape D

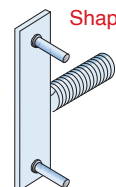

HZ07 Z Anchor For Soffits - Product Details

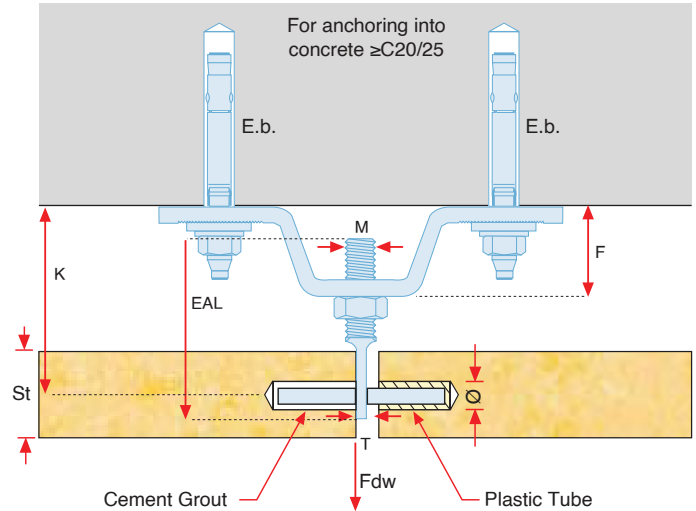

| Product Code | Technical Details | | | | | | | | | |
|--------------|-------------------|-----------------|-----------------|-----------|--------------|---------------------|----------|----------------------|-------------------------|-----------------|
| | Projection | Min. Projection | Max. Projection | Dead Load | Forming Size | Expansion Bolt Size | Pin Size | Adj. Arm Metric Size | Adj. Arm Flat Thickness | Adj. Arm Length |
| | K (mm) | K - (mm) | K + (mm) | Fdw (N) | F (mm) | E.b. (mm) | Ø (mm) | M (mm) | T (mm) | EAL (mm) |
| HZ07-452 | 45 | 40 | 55 | 200 | 10 | M8X80 | 5 | M10 | 3.5 | 60 |
| HZ07-552 | 55 | 45 | 70 | | 20 | | | | | 60 |
| HZ07-752 | 75 | 60 | 90 | | 40 | | | | | 60 |
| HZ07-952 | 95 | 80 | 110 | | 60 | | | | | 60 |
| HZ07-553 | 55 | 50 | 70 | 300 | 20 | M8X80 | 5 | M10 | 3.5 | 60 |
| HZ07-753 | 75 | 60 | 90 | | 40 | | | | | 60 |
| HZ07-953 | 95 | 80 | 110 | | 60 | | | | | 60 |
| HZ07-1153 | 115 | 100 | 130 | | 80 | | | | | 60 |
| HZ07-554 | 55 | 50 | 65 | 400 | 10 | M8X80 | 5 | M12 | 4.5 | 70 |
| HZ07-754 | 75 | 60 | 90 | | 20 | | | | | 80 |
| HZ07-954 | 95 | 80 | 110 | | 40 | | | | | 80 |
| HZ07-1154 | 115 | 100 | 130 | | 60 | | | | | 80 |

- Material : Stainless Steel 1.4301 (A2) & 1.4401 (A4).
- Table above is prepared according to Eurocode standard.
- Loads stated are working resistance loads.
- Other sizes are available for production upon request.
- Bolts are provided separately.
- Structural calculation reports are available upon order.

HZ07 Z Anchor - Soffit Anchor

- Load bearing & restraint
- Three dimensional adjustability
- Fastened on to load bearing walls with expansion bolts and on to channels with set screws
- Projection sizes between 45 and 130 mm
- Suitable for horizontal & vertical joints
- Loads up to 400 N
- Stone thickness 20-50 mm

Product Code Description

HZ07 - 45 2 A

- Shape
- Dead Load (x10 Kg)
- Projection (mm)
- Type

Shape A

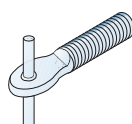

Shape B

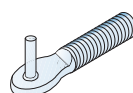

Shape C

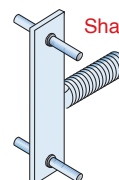

Shape D

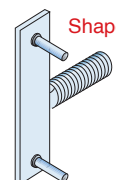

HZ08 Z Anchor - Product Details

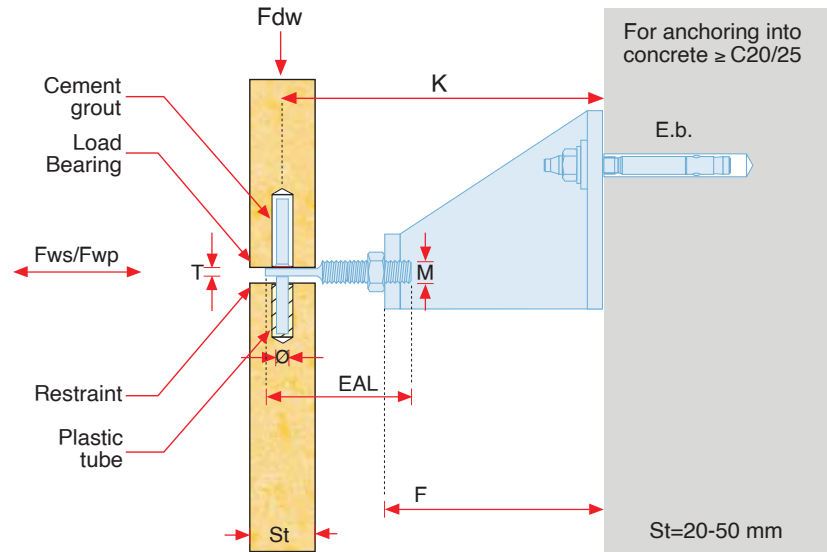

| Product Code | Technical Details | | | | | | | | | | | |
|--------------|-------------------|-----------------|-----------------|-----------|--------------|---------------|--------------|---------------------|----------|----------------------|-------------------------|-----------------|
| | Projection | Min. Projection | Max. Projection | Dead Load | Forming Size | Wind-Pressure | Wind-Suction | Expansion Bolt Size | Pin Size | Adj. Arm Metric Size | Adj. Arm Flat Thickness | Adj. Arm Length |
| | K (mm) | K - (mm) | K + (mm) | Fdw (N) | F (mm) | Fwp (N) | Fws (N) | E.b. (mm) | Ø (mm) | M (mm) | T (mm) | EAL (mm) |
| HZ08-1152 | 115 | 85 | 130 | 200 | 80 | 312 | 219 | M8x80 | 5 | M10 | 3.5 | 60 |
| HZ08-1352 | 135 | 105 | 150 | | 100 | | | | | | | 60 |
| HZ08-1552 | 155 | 135 | 170 | | 120 | | | | | | | 60 |
| HZ08-1153 | 115 | 100 | 130 | 300 | 80 | 468 | 328 | M8x80 | 5 | M10 | 3.5 | 60 |
| HZ08-1353 | 135 | 120 | 150 | | 100 | | | | | | | 60 |
| HZ08-1553 | 155 | 140 | 170 | | 120 | | | | | | | 60 |
| HZ08-1154 | 115 | 100 | 130 | 400 | 80 | 624 | 437 | M8x80 | 5 | M12 | 4.5 | 80 |
| HZ08-1354 | 135 | 120 | 150 | | 100 | | | | | | | 80 |
| HZ08-1554 | 155 | 140 | 170 | | 120 | | | | | | | 80 |
| HZ08-1155 | 115 | 85 | 130 | 500 | 80 | 780 | 546 | M8x80 | 5 | M12 | 4.5 | 60 |
| HZ08-1355 | 135 | 105 | 150 | | 100 | | | | | | | 60 |
| HZ08-1555 | 155 | 135 | 170 | | 120 | | | | | | | 60 |
| HZ08-1156 | 115 | 100 | 130 | 600 | 80 | 936 | 655 | M10x90 | 6 | M14 | 5.5 | 60 |
| HZ08-1356 | 135 | 120 | 150 | | 100 | | | | | | | 60 |
| HZ08-1556 | 155 | 140 | 170 | | 120 | | | | | | | 60 |
| HZ08-1158 | 115 | 100 | 130 | 800 | 80 | 1235 | 865 | M10x90 | 6 | M14 | 5.5 | 80 |
| HZ08-1358 | 135 | 120 | 150 | | 100 | | | | | | | 80 |
| HZ08-1558 | 155 | 140 | 170 | | 120 | | | | | | | 80 |

- Material : Stainless Steel 1.4301 (A2) & 1.4401 (A4).
- Table above is prepared according to Eurocode standard.
- Loads stated are working resistance loads.
- Other sizes are available for production upon request.
- Bolts are provided separately.
- Structural calculation reports are available upon order.

HZ08 Z Anchor

- Load bearing & restraint
- Three dimensional adjustability
- Fastened on to load bearing walls with expansion bolts and on to channels with set screws
- Projection sizes between 115 and 170 mm
- Suitable for horizontal & vertical joints
- Loads up to 400 N
- Stone thickness 20-50 mm

Product Code Description

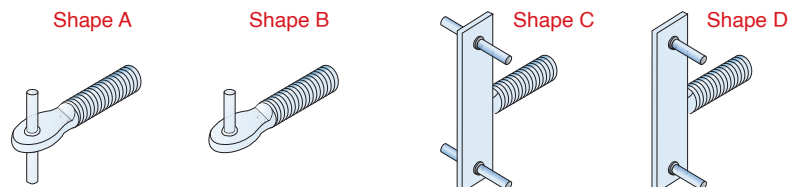
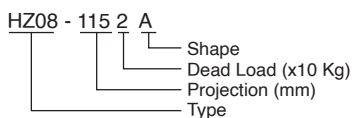

HZ02-S Z Anchor - Product Details



LGA TEST REPORT
No : BBW 121 51 21
Date : 15.10.2006

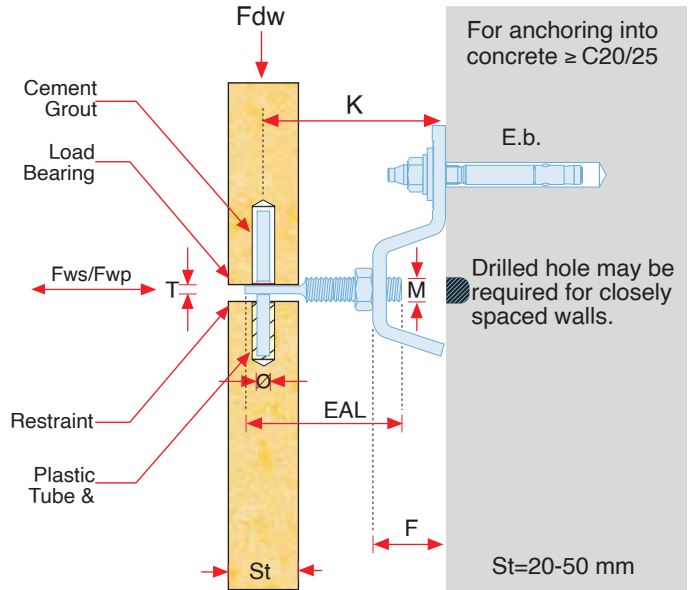
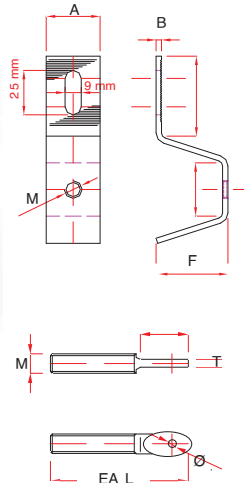

| Product Code | Technical Details | | | | | | | | | | | |
|------------------|-------------------|-----------------|-----------------|-----------|--------|---------------|--------------|-----------|--------------|----------------------|-------------------------|-----------------|
| | Projection | Min. Projection | Max. Projection | Dead Load | Offset | Wind-Pressure | Wind-Suction | Bolt Size | Pin Diameter | Adj. Arm Metric Size | Adj. Arm Flat Thickness | Adj. Arm Length |
| | K (mm) | K - (mm) | K + (mm) | Fdw (N) | F (mm) | Fwp (N) | Fws (N) | E.b. (mm) | Ø (mm) | M (mm) | T (mm) | EAL (mm) |
| HZ02-S-33010/10 | 40 | 40 | 50 | 500 | 10 | 350 | 220 | M8x80 | ø 5x70 | M10 | 3.5 | 50 |
| HZ02-S-33015/10 | 45 | 45 | 55 | 500 | 15 | | | | | | | 50 |
| HZ02-S-33020/10 | 50 | 50 | 60 | 500 | 20 | | | | | | | 50 |
| HZ02-S-33030/10 | 65 | 50 | 80 | 400 | 30 | | | | | | | 60 |
| HZ02-S-33040/10 | 75 | 60 | 90 | 400 | 40 | | | | | | | 60 |
| HZ02-S-33050/10 | 85 | 70 | 100 | 400 | 50 | | | | | | | 60 |
| HZ02-S-33060/10 | 95 | 80 | 110 | 300 | 60 | | | | | 60 | | |
| HZ02-S-33080/10 | 125 | 110 | 140 | 300 | 80 | | | | | 70 | | |
| HZ02-S-330100/10 | 145 | 130 | 160 | 250 | 100 | | | | | 70 | | |
| HZ02-S-330120/10 | 165 | 150 | 180 | 250 | 120 | | | | | 70 | | |
| HZ02-S-43020/12 | 60 | 55 | 70 | 500 | 20 | | | | | M12 | 4.5 | 70 |
| HZ02-S-43040/12 | 90 | 75 | 105 | 500 | 40 | | | | | | | 80 |
| HZ02-S-43060/12 | 110 | 95 | 125 | 400 | 60 | 80 | | | | | | |
| HZ02-S-43080/12 | 130 | 115 | 145 | 400 | 80 | 80 | | | | | | |
| HZ02-S-430100/12 | 150 | 135 | 165 | 300 | 100 | 80 | | | | | | |
| HZ02-S-430120/12 | 170 | 155 | 185 | 300 | 120 | 80 | | | | | | |

- Material : Stainless Steel 1.4301 (A2) & 1.4401 (A4).
- Table above is prepared according to LGA test results.
- Loads stated are characteristic resistance loads.
- Bolts are provided separately.
- Max Wind pressure: 350 N
- Test results are available upon order.

HZ02-S type Z anchors with standard sizes. Different types available according to desired method of fixation.

HZ02-2S Type without serration and with plain washer.

HZ05-S Type with riveted nut. Serrated with serrated washer.

HZ05-2S Type with riveted nut. Without serration and with plain washer.

Shape A

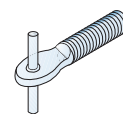

Shape B

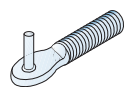

Product Code Description

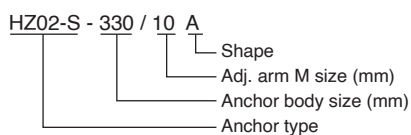

Shape C

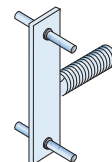

Shape D

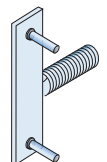

HZ Z Anchor - Special Applications

HZ03 Special Z Anchor

Used for installing soffit and facade panels with a single anchor

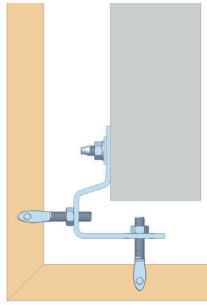
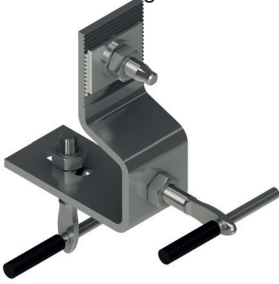

HZ06 Special Z Anchor - for large projection sizes

With optimal static performance
Can be used for projections over 150 mm

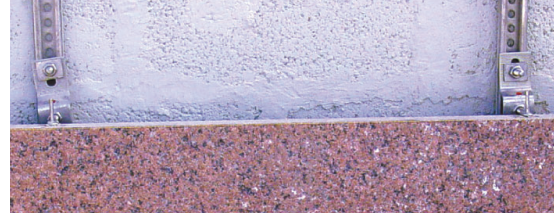
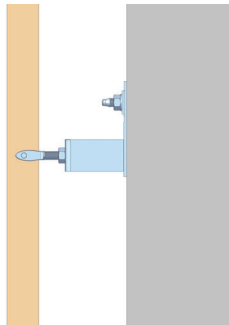
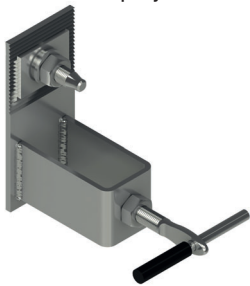

HZ09 Z Anchor - with wedge washer

Can be used for loads that are over 800 N when
stronger vertical stabilization is required

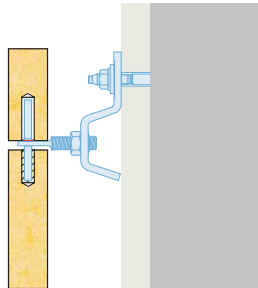

Special designs

Z Anchors are fixed on sub frame to
install cornice lining.

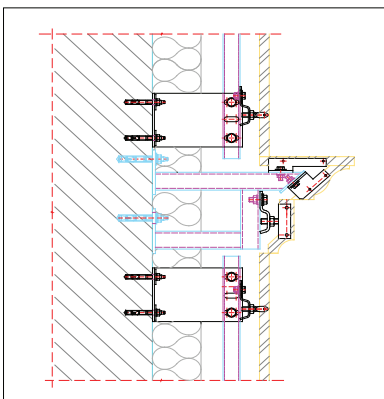

Z Anchors are fixed on to special steel
structure for cornice parapet
installation.

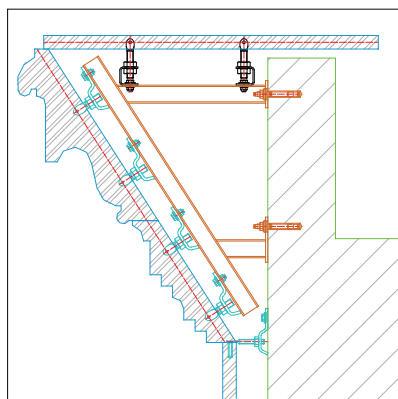

Z Anchors are fixed on to special steel
structure for special area installation.

